

SELF-ADHERED

Products for the Entire Building Envelope



HIGH PERFORMANCE SELF-ADHESIVE MEMBRANES

Since 1908, SOPREMA has been a worldwide leader in the manufacturing of waterproofing membranes for building envelope and civil engineering projects.

Self-adhered membranes eliminate the need for torches, asphalt and adhesives, making our systems environmentally friendly and safer to install. Self-adhering systems are ideal for schools, hospitals and office buildings.

With dozens of self-adhered products to choose from, SOPREMA has the right product for your building envelope waterproofing needs.

SOPREMA PRODUCTS AND APPLICATIONS

Below Grade

Featured Products

Self-adhered waterproofing for:

Concrete	Colphene 3000
Insulated Concrete Forms	Colphene ICF

Air Barrier

Self-adhered membrane that seals:

Building Walls	Sopraseal 1100T
Windows/Doors	Sopraseal WeatherFlash

Vapor Barrier

Self-adhered membrane that seals:

Metal Decks	Sopravap'r
-------------	------------

Underlayment

Self-adhered membrane that protects:

Roofing	Lastobond Shield HT
---------	---------------------

Roofing

Self-adhered SBS membranes that cover the:

Roof	Sopralene Stick/Colphene FR GR
------	--------------------------------

SELF-ADHERED

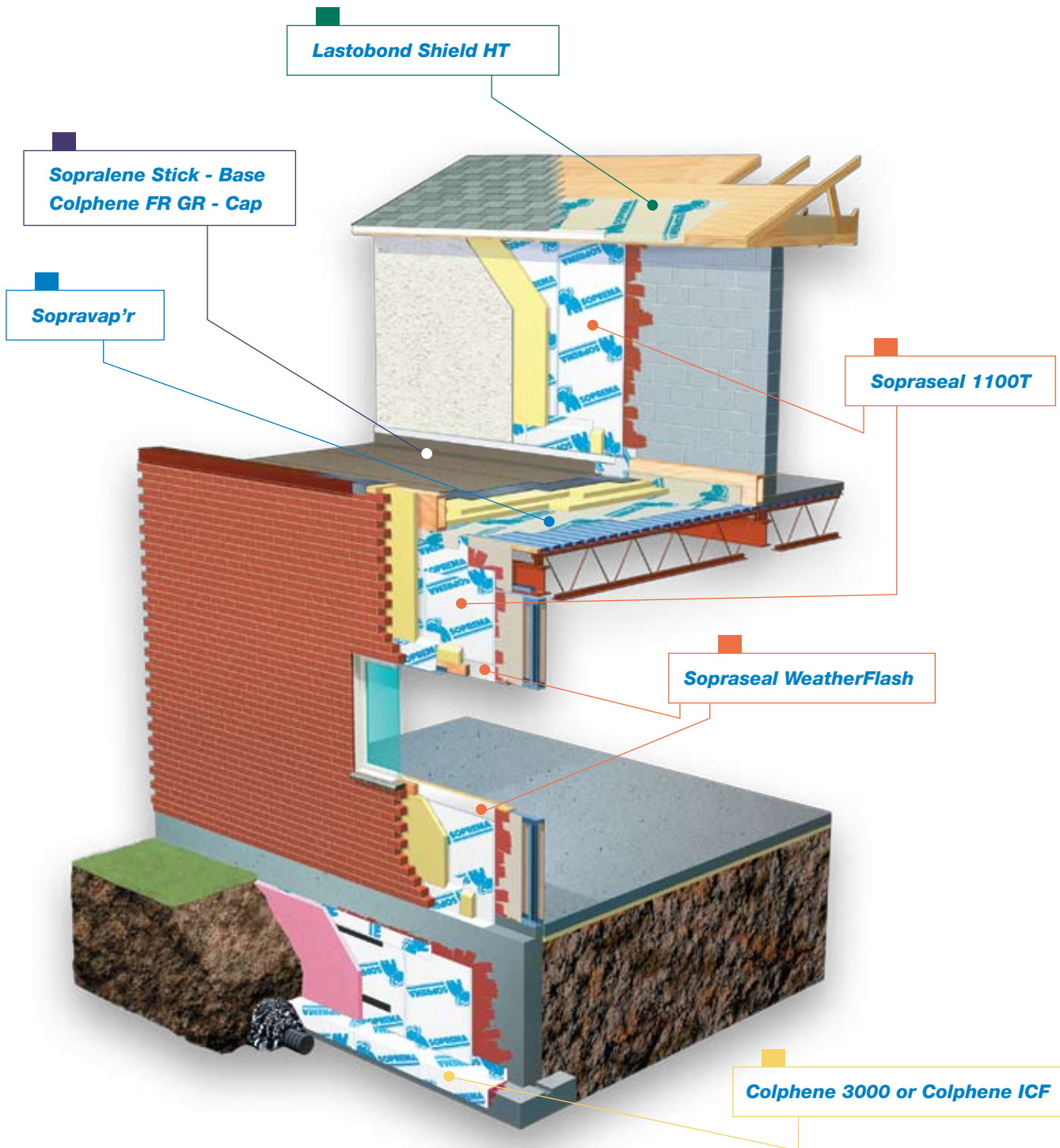

SELF-ADHERED SOLUTIONS FOR THE ENTIRE BUILDING ENVELOPE

BELOW GRADE

COLPHENE 3000 | COLPHENE ICF

SOPREMA sets new standards in self-adhered, below grade waterproofing solutions. Made with the most reliable self-adhesive SBS modified bitumen in the industry, SOPREMA's below grade products guarantee performance. Water exerts a pressure on a vertical surface of over 60 pounds per cubic foot and increases as the depth increases. Don't take chances on water penetration – trust SOPREMA below grade waterproofing solutions.

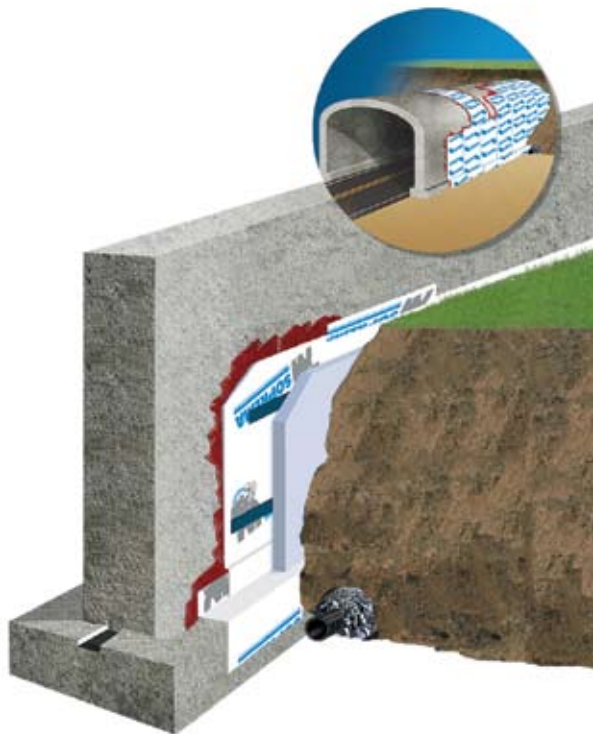

COLPHENE 3000 and COLPHENE 60* are self-adhered waterproofing membranes composed of SBS modified bitumen and a polyethylene woven composite (Colphene 3000) or polyester (Colphene 60) facer. COLPHENE 3000 is the ideal waterproofing membrane for:

- Foundations
- Below grade walls
- Tunnels
- Plaza decks
- Parking decks
- Split-slab construction
- Concrete substrates



COLPHENE 3000 Advantages:

- Highly flexible, easily conforms to substrate
- Tremendous resistance to hydrostatic pressure
- Fully adhered, watertight laps
- Consistent thickness
- 100% UV stable
- Superior tensile strength & puncture resistance
- Cold applied, no flames or kettles
- Tenacious adhesion to most substrates

COLPHENE ICF and COLPHENE 40* are self-adhered, below grade waterproofing membranes composed of SBS modified bitumen and a polyethylene woven composite (Colphene ICF) or polyester (Colphene 40) facer. COLPHENE ICF is ideal for use on ICF formwork systems or extruded polystyrene substrates.

COLPHENE ICF Features:

- Easy installation
- Consistent thickness
- High tensile strength
- High puncture resistance
- 100% UV protection
- Precut rolls available

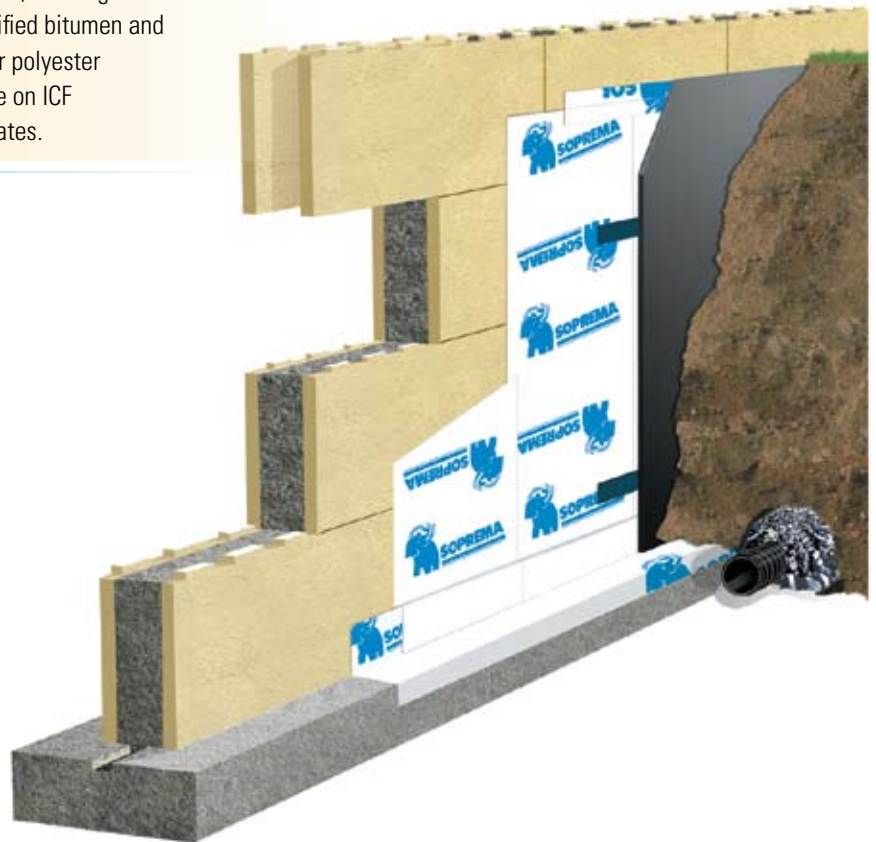

*These below grade products are made in the USA. For physical properties, please go to www.soprema.us or call 800.356.3521.

AIR BARRIER

SOPRASEAL 1100T | SOPRASEAL WEATHERFLASH

Protection Against Air and Moisture Penetration

SOPRASEAL STICK 1100T and SOPRASEAL WEATHERFLASH are composed of self-adhesive SBS modified bitumen and a polyethylene woven composite facer. Establishing an impermeable barrier against air and vapor leakage in building envelope applications, both products will reduce energy costs and provide a more comfortable indoor living environment while providing superior waterproofing protection.



SOPRASEAL STICK 1100T

Features:

- Easy installation
- Reference lines at 6"
- Consistent thickness
- Self-sealing
- 100% UV protection
- Precut rolls available

sopraseal WeatherFlash

Features:

- Provides a continuous air/vapor barrier
- Eliminates drafts and water leaks
- Self-sealing around nails and screws
- Can be sprayed with polyurethane foam
- 100% UV protection



VAPOR BARRIER

SOPRAVAP'R

Keep Working

SOPRAVAP'R membrane is composed of self-adhesive SBS modified bitumen and a polyethylene woven composite facer. Designed as a premium vapor barrier for metal decks, SOPRAVAP'R features a specially designed width of 45" that allows the longitudinal seams to coincide with the top flutes of the deck, reducing waste and increasing the coverage capacity of a single roll.



SOPRAVAP'R Features:

- Quick and easy release film
- Self-sealing
- Temporarily protects against inclement weather
- Slip resistant
- No substrate board needed
- 100% UV protection
- Puncture resistant
- No primer required
- Ideal for mechanically fastened or cold applied systems
- High tensile strength, resistant to work crew traffic

VAPOR BARRIER



ROOF UNDERLAYMENTS

LASTOBOND SHIELD HT

High Temperature Underlayment Solution

LASTOBOND SHIELD HT is a 40 mil, self-adhesive waterproofing membrane composed of SBS modified bitumen and a tough, UV resistant, anti-slip polyethylene woven top facer. The release film backing is also UV resistant and protects the product from degradation when stored outside and unboxed. LASTOBOND SHIELD HT is designed for use in hot climates where in-service temperatures may reach as high as 240° F.



LASTOBOND SHIELD HT Features:

- Easy installation
- Self-sealing
- Heat reflective
- Slip resistant
- High tensile strength
- 100% UV protection
- No primer required when covered within 24 hours
- Provides up to 90 days exposure



Also Available:

LASTOBOND MU (metal underlayment)

LASTOBOND TU (tile underlayment)

LASTOBOND S (shingle underlayment)

LASTOBOND ECO (shingle underlayment)

ROOFING MEMBRANES

SOPRALENE STICK | COLPHENE FR GR

SOPREMA offers a wide range of self-adhesive SBS modified bitumen roofing membranes designed for numerous applications. The most popular system is Sopralene Stick/Colphene FR GR. Sopralene Stick base ply is composed of selected SBS modified bitumen applied to a non-woven polyester reinforcement with self-adhesive bitumen on the underside and a sanded topside surface. Colphene FR GR self-adhesive membrane is composed of a special elastomeric modified bitumen blend of SBS and other polymers which are applied to glass mat or glass mat/glass gird composite reinforcement. Colphene FR GR has a self-adhesive underside and granulated topside.

Other self-adhered SBS modified bitumen roofing membranes are available. Please go to www.soprema.us or call 800.356.3521 for more details.

PRIMERS

ELASTOCOL STICK WB | ELASTOCOL 600c

Both ELASTOCOL STICK WB and ELASTOCOL 600c primers have been specially formulated for use with self-adhered products. ELASTOCOL STICK WB is a polymer emulsion-based primer designed to improve the adhesion of self-adhesive waterproofing membranes on horizontal and vertical substrates. This primer contains NO VOCs. ELASTOCOL 600c primer is a blend of natural resins, solvent/synthetic rubber and is used on horizontal and vertical substrates prior to self-adhered field and flashing base membrane applications.



COLPHENE 3000

PROPERTIES	STANDARDS	COLPHENE 3000
Thickness	-	60 mils
Dimensions	-	39 in x 61 ft
Approximate Roll Coverage	-	200 ft ²
Approximate Roll Weight	-	64 lbs
Topside	-	Tri-Laminate Woven Polyethylene
Underside	-	Self-Adhesive with Release Film
Tensile Strength (MD/XD)	ASTM D412	23.7/18.5 Mpa
Ultimate Elongation (MD/XD)	ASTM D412	67/74 %
Low Temperature Flexibility	ASTM D1970	Unaffected at -24° F
Puncture Resistance	ASTEM E154	1210 N
Tear Resistance	ASTM D5601	125 N
Lap Peel Adhesion	ASTM D1876	1360 N/m
Water Absorption	ASTM D570	0.5% max
Adhesion to Poured Concrete	ASTM D903 modified	2880 N/m
Elongation of Rubberized Asphalt	ASTM D5147	>1000
Water Vapor Transmission (Permeance)	ASTM E96 (Proc. B)	0.21 perm
Crack Cycling at -23°C	ASTM C836	Unaffected
Resistance to Hydrostatic Head	ASTM D5385 modified	> 70 m

COLPHENE ICF

PROPERTIES	STANDARDS	COLPHENE ICF
Thickness	-	40 mils
Dimensions	-	36 in x 75 ft
Approximate Roll Coverage	-	225 ft ²
Roll Weight	-	44 lbs
Topside	-	Tri-Laminate Woven Polyethylene
Underside	-	Self-Adhesive with Release Film
Tensile Strength (MD/XD)	ASTM D5147	64/88 lb/in
Ultimate Elongation (MD/XD)	ASTM D5147	52/24 %
Low Temperature Flexibility	ASTM D5147	Unaffected at -22 F°
Static Puncture Resistance	ASTM D5602	90 lbs
Tear Resistance (MD/XD)	ASTM D5601	84/90 lb
Lap Adhesion	ASTM D1876	11.4 lb/in
Peel Resistance	ASTM D903	17.5 lb
Water Absorption	ASTM D5147	< 0.1%
Water Vapor Transmission (Permeance)	ASTM E96 (Proc. B)	0.016 perm
Application T°	Summer Grade	Temperatures Above 50 F°
	Winter Grade	Temperatures Between 25 - 50 F°

SOPRASEAL STICK 1100T

PROPERTIES	STANDARDS	SOPRASEAL STICK 1100T
Thickness	-	40 mil
Dimensions	-	36 in x 75 ft
Gross/Net Coverage per Roll	-	225/212 (ft ²)
Roll Weight	-	46 lbs
Topside	-	Tri-Laminate Woven Polyethylene
Underside	-	Silicone Release Film
Tensile Strength (MX/DX)	ASTM D5147	64/88 lb/in
Ultimate Elongation (MX/DX)	ASTM D5147	40/25 %
Cold Bending	ASTM D5147	-31° F
Static Puncture	ASTM D5602	90 lbf
Tear Resistance (MX/DX)	ASTM D5601	84/90 lbf
Lap Adhesion	ASTM D1876	11.4 lb/in
Water Absorption	ASTM D5147	0.1% max
Peel Resistance	ASTM D903	16 lbf/ft
Air Permeability	ASTM E283 (75 Pa)	<0.0003 L/sec-m ²
Water Vapor Transmission (Permeance)	ASTM E96 (Proc. B)	0.016 perm
Resistance to Gust Wind Load	ASTM E330 (3000 Pa - 10 s)	No signs of delamination or variation in the air permeability
Resistance to Sustained Wind Load	ASTM E330 (100 Pa - 1 hr)	No signs of delamination or variation in the air permeability

SOPRASEAL WEATHERFLASH

PROPERTIES	STANDARDS	SOPRASEAL WEATHERFLASH
Thickness	-	25 mils
Dimensions	-	75 ft rolls-widths of 4, 6, 9, 12, 18 & 36 in
Approximate Roll Weight (36" roll)	-	55 lbs
Topside	-	Tri-Laminate Woven Polyethylene
Underside	-	Clear Silicone Release Film
Tensile Strength (MD/XD)	ASTM D5147	64/88 lb/in
Ultimate Elongation (MD/XD)	ASTM D5147	40/25 %
Low Temperature Flexibility	ASTM D1970	Unaffected at -22° F
Static Puncture	ASTM D5602	90 lbf
Tear Resistance (MD/XD)	ASTM D5601	84/90 lbf
Lap Adhesion	ASTM D1876	6.8 lbf/in
Water Absorption	ASTM D5147	0.1% max
Water Vapor Transmission (Permeance)	ASTM E96 (Proc. B)	0.016 perm
Air Permiability	ASTM E283 (75 Pa)	5.8 - 10-5 ft ³ /min - ft ²
Resistance to Hydrostatic Head	ASTM D5385 modified	> 70 m

SOPRAVAP'R

PROPERTIES	STANDARDS	SOPRAVAP'R
Thickness	-	31.5 mils
Dimensions	-	45 in x 133 ft
Gross/Net Coverage per Roll	-	500 ft ²
Roll Weight	-	82 lbs
Topside	-	Tri-Laminate Woven Polyethylene
Underside	-	Silicone Release Film
Tensile Strength (MD/XD)	ASTM D5147	64/88 lbf/in
Ultimate Elongation (MD/XD)	ASTM D5147	52/24 %
Cold Bending	ASTM D5147	-31° F
Static Puncture	ASTM D 5602	90 lbf
Tear Resistance (MD/XD)	ASTM D 5601	84/90 lbf
Lap Adhesion	ASTM D1876	138 lbf
Breaking Strength (MD/XD)	ASTM D5147	64/88 lb/in
Water Absorption	ASTM D5147	0.1% max
Peel Resistance	ASTM D903	83 lbf/ft
Air Permeability	ASTM E283 (75 Pa)	<0.007 L/sec-m ²
Water Vapor Transmission (Permeance)	ASTM E96 (Proc. B)	0.017 perm

LASTOBOND SHIELD HT

PROPERTIES	STANDARDS	LASTOBOND SHIELD HT
Thickness	-	40 mils
Dimensions	-	36 in x 67 ft
Approximate Gross Roll Coverage	-	200 ft ²
Roll Weight	-	43 lbs
Topside	-	Tri-Laminate Polyethylene
Underside	-	Self-Adhered with Release Material
Load Strain Properties at 77° F (MD/XD)	ASTM D1204	64/88 lb/in
Ultimate Elongation (MD/XD)	ASTM D1970	52/24 %
Low Temperature Flexibility	ASTM D1970	-22° F
Peel Resistance	ASTM D903	11.4 lb/ft
Maximum Service Temperature		240° F
Water Vapor Transmission (Permeance)	ASTM E96 (Proc. B)	0.017 perm
Air Permiability	ASTM E283	<0.007 L/sec-m ²

ESTIMATOR GUIDE

PRODUCTS	PACKAGING	ROLLS/PAILS PER PALLET	GROSS COVERAGE
COLPHENE 3000	39 in x 61 ft	25	200 ft ²
COLPHENE ICF	36 in x 75 ft	25	225 ft ²
SOPRASEAL STICK 1100T	36 in x 75 ft	36	225 ft ²
SOPRASEAL WEATHERFLASH	4, 6, 9, 12, 18 & 36 in x 75 ft	36	225 ft ²
SOPRAVAP [®] R	45 in x 133 ft	25	500 ft ²
LASTOBOND SHIELD HT	36 in x 67 ft	25	200 ft ²
ELASTOCOL STICK WB	5 GALLON	32	Up to 500 ft ² /gal depending on surface & porosity
ELASTOCOL 600c	5 GALLON	36	100-150 ft ² /gal depending on surface & porosity

PRIMER REQUIREMENT

PRODUCTS	WOOD	STEEL	CONCRETE	ICF
COLPHENE 3000	YES	N/A	YES	NO
COLPHENE ICF	YES	N/A	NO	YES
SOPRASEAL STICK 1100T	YES	N/A	YES	N/A
SOPRASEAL WEATHERFLASH	YES	N/A	YES	N/A
SOPRAVAP [®] R	YES	YES	YES	N/A
LASTOBOND SHIELD HT	YES**	YES	YES	N/A

*Cut rolls available

**If covering is to be made within 24 hours, the use of primer is optional.

Note: Other substrates not listed must be primed.

To Protect is to Serve...



As a worldwide leader in waterproofing, SOPREMA is dedicated to sustainable development. Green roof products such as Sopranature, building integrated photovoltaic systems such as Soprasolar and solvent free resins such as Alsan 2K Zero help to illustrate our commitment to a greener planet. As a symbol of our environmental initiative, SOPREMA has chosen the ginkgo biloba leaf. This Oriental tree of ancient origin represents sustainability, health, esthetics and resistance to attack. We feel it is an appropriate symbol of our continuing efforts to provide our children with a safer, healthier world.



www.soprema.us

SOPREMA, Inc.
310 Quadral Drive
Wadsworth, OH 44281

1.800.356.3521