

* LAP SEAM MUST BE ROLLED WITH APPROVED ROLLER.

← MINIMUM 5" (13cm) LAP FULLY WELD AROUND MEMBRANE PLATE; LAP IS HOT AIR WELDED OR UNROLLED AS THE LAP IS BEING HEAT WELDED. SEE NOTE 2. →
 ← 12" (30.5cm) MINIMUM LAP OFFSET FROM CAP MEMBRANE TO SOPRAPHIX MEMBRANE SIDE & END LAPS →
 SEE DETAIL: SFMA-097

CENTER #14 OR #15 FASTENER W/ SOPRAPHIX 2" PLATE IN SIDELAP SEAM. SEE CURRENT SOPRAPHIX PDS FOR INSTALLATION PROCEDURES.

SOPREMA SBS FIELD CAP MEMBRANE PLY HEAT WELDED. SEE NOTE 1.

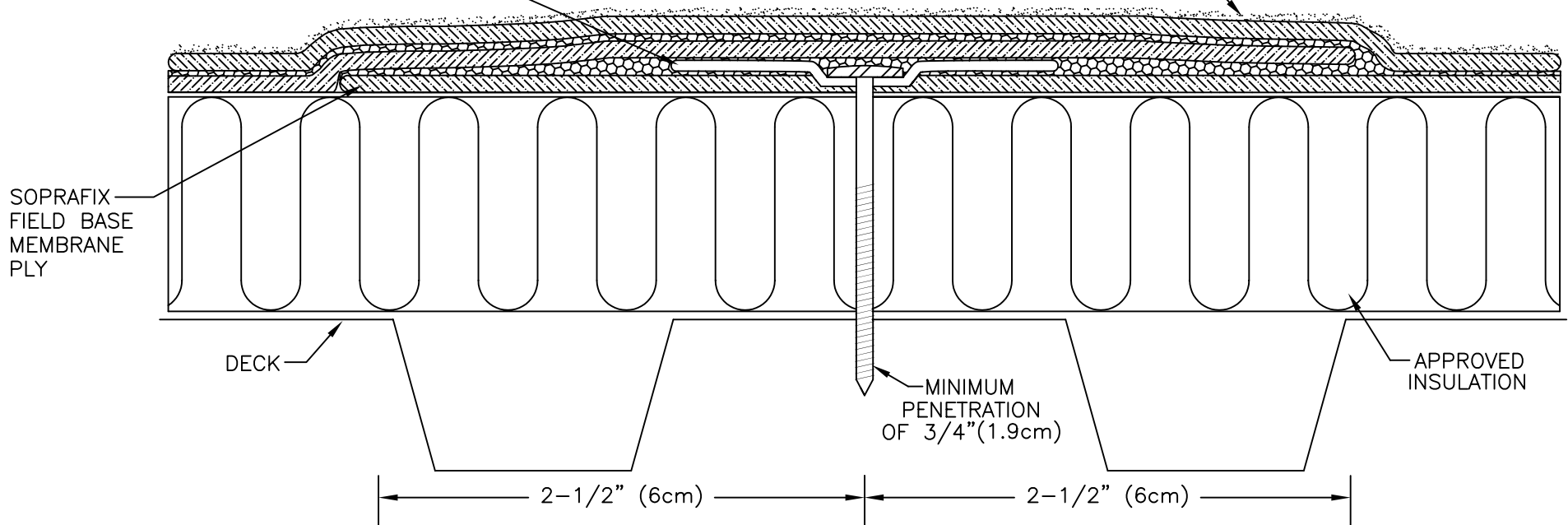

SOPRAPHIX FIELD BASE MEMBRANE PLY LAYOUT
SEE FASTENING PATTERN DETAILS: SFMA-016 & SFMA-017

NOTES:

1. DETAIL TO BE USED IN CONJUNCTION WITH SOPREMA GENERAL REQUIREMENTS AND APPROVED DETAILS FOR FM APPROVALS (FMG) APPROVED STEEL & CONCRETE DECKS. **SEE FMG AND ICC/ES LISTINGS FOR APPROVED CONSTRUCTIONS.**
2. FOR WIND RIDERS GREATER THAN 63 MPH @ 3-SEC GUST: ROOFING CONTRACTOR IS RESPONSIBLE TO OBTAIN FROM SOPREMA'S CORPORATE TECHNICAL DEPARTMENT PRIOR TO BIDDING OR JOB-START, APPROVED FASTENING PATTERNS (FASTENER WITHDRAWAL VALUES CAN CHANGE ACTUAL FASTENER SPACING APPROVED) AND THE NUMBER OF REQUIRED PERIMETER ROLLS. IF APPROVAL IS NOT OBTAINED PRIOR TO INSTALLATION, THE COST OF INSTALLING ADDITIONAL FASTENERS WILL BE BORNE BY THE RESPONSIBLE PARTY.
3. FMG PERIMETER DEFINITION: X=4/10 OF BUILDING HEIGHT OR 1/10 THE BUILDING WIDTH, WHICHEVER IS THE LESSER DIMENSION. SOPREMA REQUIRES A MINIMUM OF 3 PERIMETER ROLLS. THE NUMBER OF PERIMETER ROLLS AND **FASTENER DENSITIES MAY INCREASE WHEN WIND WARRANTY RIDERS ARE APPROVED.**



310 QUADRAL DRIVE
 WADSWORTH, OHIO 44281
 (330) 334-0066

TITLE Soprafix FMG 1-120 w/2" Plate & 5" Lap			
SCALE NONE	DWN DMT	CHK BS	APPROVAL DATE 11/17/06
DRAWING NUMBER SFMA-015			REV 0

** USAGE OF THIS DRAWING IS GOVERNED BY THE TERMS OF SERVICE FOR SOPREMA DETAIL. PLEASE CONSULT THESE TERMS OF SERVICE PRIOR TO UTILIZING THIS DRAWING.