

TRAFIK HP 540 (CLEAR FINISH COAT)  
 TRAFIK HP 530 (WEAR COAT & AGGREGATE)  
 TRAFIK HP 520 (WATERPROOFING LAYER)  
 TRAFIK HP 510 PRIMER

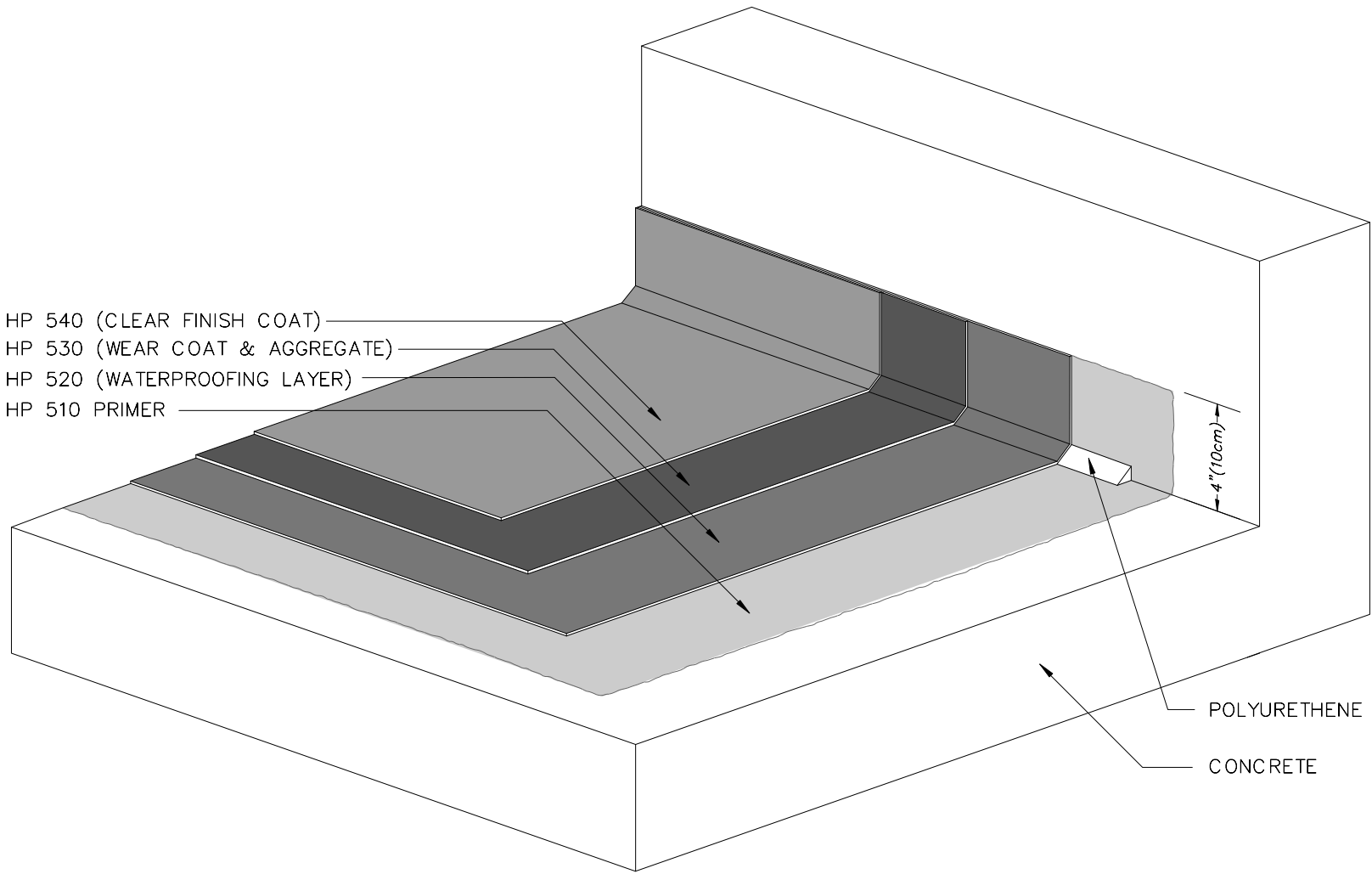

POLYURETHANE SEALANT  
 CONCRETE

NOTES:

1. DETAIL TO BE USED IN CONJUNCTION WITH SOPREMA GENERAL REQUIREMENTS, APPLICATION METHODS AND APPROVED DETAILS.



310 QUADRAL DRIVE  
 WADSWORTH, OHIO 44281  
 (330) 334-0066

TITLE ALSAN TRAFIK HP 500 FLASHING TERMINATION				
SCALE NONE	DWN PBF	CHK SR	APPROVAL DATE 4/03/09	REV 0
DRAWING NUMBER T-05				REV 0

\*\* USAGE OF THIS DRAWING IS GOVERNED BY THE TERMS OF SERVICE FOR SOPREMA DETAIL. PLEASE CONSULT THESE TERMS OF SERVICE PRIOR TO UTILIZING THIS DRAWING.